

REVISIONS LIST				
REV	ECO #	DESCRIPTION	DATE	APV'D
A		Initial Release		

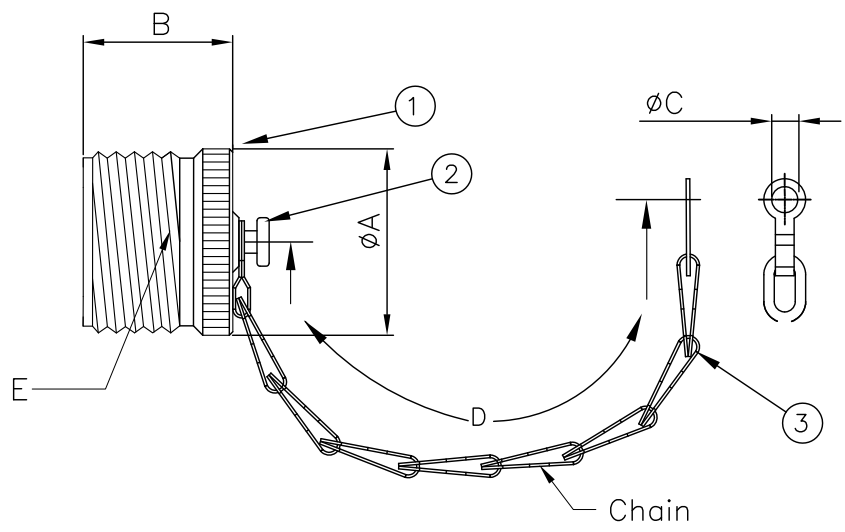

**SPECIFICATIONS**

Environmental

Operating Temperature (Max)	+125°C
Salt Spray	
Electrophoresis Green (Non-Conductive)	96 Hrs
Electroless Nickel (Conductive)	48 Hrs

Shell Size	phi A ±2.0	B ±1.0	phi C +0.3/0.0	D ±10.0	E Thread (UNEF2A)
10	17.5	16.5	3.8	115.0	0.625-24
14	24.0	21.0	3.8	115.0	0.875-20
16	27.0	21.0	3.8	115.0	1.000-20
18	31.0	21.0	3.8	115.0	1.125-18
20	33.0	21.0	3.8	140.0	1.250-18
22	36.0	21.0	3.8	140.0	1.375-18
24	40.0	21.0	3.8	140.0	1.500-18
28	46.0	21.0	3.8	200.0	1.750-18
32	52.5	21.0	3.8	200.0	2.000-18
36	59.0	21.0	3.8	200.0	2.250-16
40	65.0	21.0	3.8	200.0	2.500-16

No.	Name	Material/Finish	Remarks
1	Shell	Aluminum	
2	Fastener	Stainless Steel	
3	Chain & End	Stainless Steel	

UNLESS NOTED TOLERANCES ARE: .X ± 0.38 .XX ± 0.25 ANGLES ± 1°	THIRD ANGLE PROJECTION 	 1170 S. PATTON ST. XENIA, OHIO 45385 PH: (937) 374-2700 FX: (937) 374-2717
--	----------------------------	---

UNIT: mm	DRWN: RLM	THESE DRAWINGS AND SPECIFICATIONS ARE THE PROPERTY OF  AND SHALL NOT BE COPIED, USED OR RE-PRODUCED WITHOUT PERMISSION.	TITLE Commercial 5015 Protective Cover Plug	
SCALE: NTS	DATE: 11/10/17		SPI P / N: S-MS25042-XX-XX	
	CHK'D: TRH		REV: A	
SHEET: 1 OF 1	APV'D: TRH		CUSTOMER P / N:	