

REVISIONS LIST				
REV	ECO #	DESCRIPTION	DATE	APV'D
A		Initial Release		

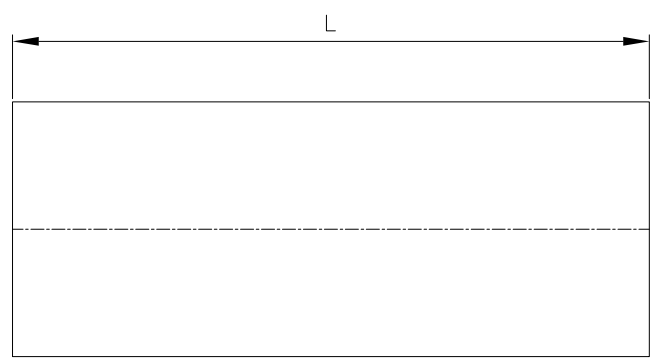
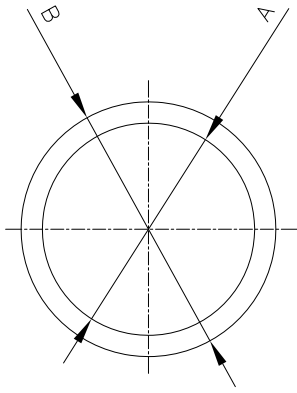

Dash Number	Color Code	A		B		L ±0.25
		Min	Max	Min	Max	
8	Green	10.20	10.40	11.40	11.60	6.40
10	Red	14.90	15.10	16.80	17.30	11.20
12	Red	14.90	15.10	16.80	17.30	11.20
14	Blue	17.90	18.20	19.80	20.30	11.20
16	Gray	21.20	21.50	23.10	23.60	11.20
18	Brown	25.50	25.80	27.40	27.90	11.20
20	Green	28.60	28.80	30.50	31.00	11.20
22	Pink	31.60	31.90	33.50	34.00	11.20
24	Orange	33.70	34.00	35.60	36.10	11.20

No.	Name	Material/Finish	Remarks
1	Crimp Ring	Copper	Tin Plated

UNLESS NOTED TOLERANCES ARE: .X ± 0.38 .XX ± 0.25 ANGLES ± 1°	THIRD ANGLE PROJECTION 		1170 S. PATTON ST. XENIA, OHIO 45385 PH: (937) 374-2700 FX: (937) 374-2717
--	----------------------------	--	---

U N I T : mm	D R W N : RLM	THESE DRAWINGS AND SPECIFICATIONS ARE THE PROPERTY OF SPI AND SHALL NOT BE COPIED, USED OR RE-PRODUCED WITHOUT PERMISSION.	T I T L E Commercial Back Shell	
S C A L E : NTS	D A T E : 08/30/21		S P I P / N : SPI85049/26-2-XXX	
	C H K ' D : TRH		R E V : A	
S H E E T : 1 OF 1	A P V ' D : TRH		C U S T O M E R P / N :	