

REVISIONS LIST				
REV	ECO #	DESCRIPTION	DATE	APV'D
A		Initial Release		

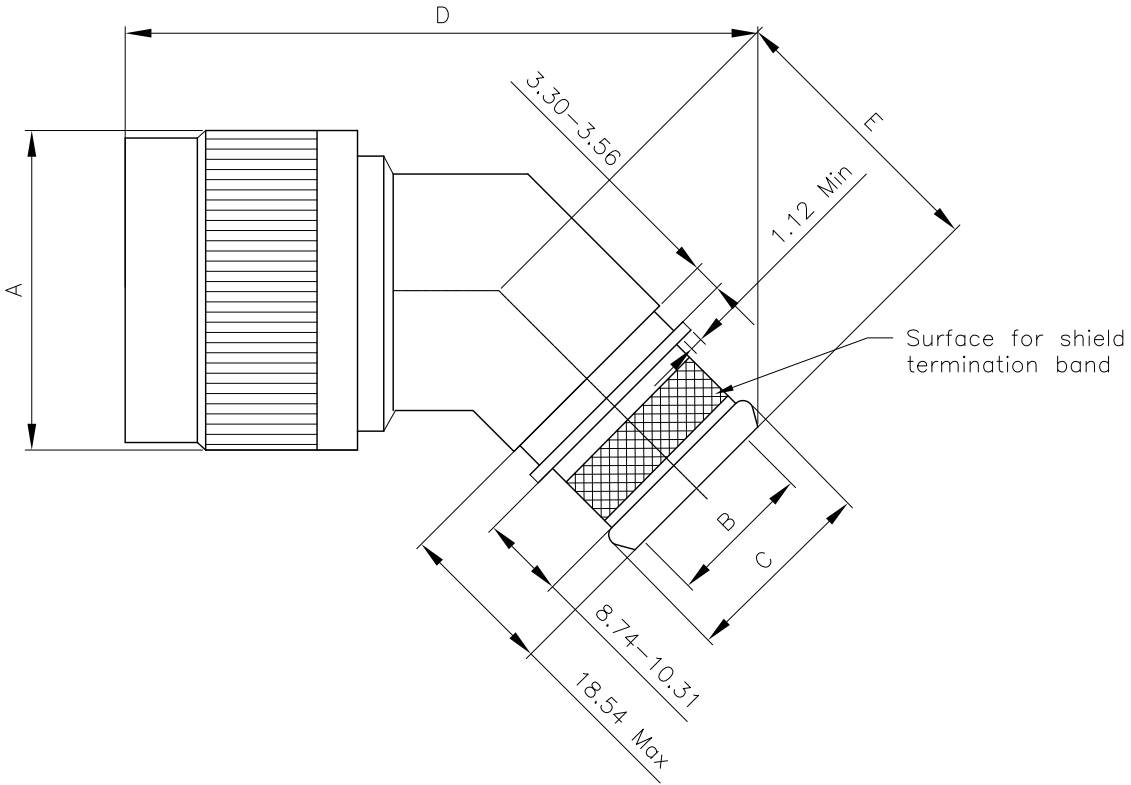

Shell Size	A Max	B		C		D		E Max
		±0.25		Ref		Ref		
		Entry Size						
		02	03	02	03	02	03	
08	22.48	N/A	6.35	N/A	10.03	N/A	54.23	29.46
10	25.65	N/A	7.92	N/A	11.61	N/A	55.65	29.97
12	28.83	7.92	11.13	11.61	14.81	56.77	57.91	30.48
14	32.00	11.13	14.27	14.81	17.96	58.78	59.89	30.99
16	35.18	12.70	15.88	16.38	19.56	60.38	61.49	31.75
18	38.35	15.88	19.05	19.56	22.73	62.18	63.30	32.00
20	41.53	15.88	20.62	19.56	24.31	63.22	64.92	32.77
22	44.70	17.48	23.83	21.06	27.51	64.87	67.16	33.27
24	47.88	19.05	25.40	22.73	29.08	66.52	68.76	34.04

No.	Name	Material/Finish	Remarks
1	Shell	Aluminum	
2	Fastners	Stainless Steel	Passivated

UNLESS NOTED TOLERANCES ARE: .X ± 0.38 .XX ± 0.25 ANGLES ± 1°	THIRD ANGLE PROJECTION 	 1170 S. PATTON ST. XENIA, OHIO 45385 PH: (937) 374-2700 FX: (937) 374-2717
--	----------------------------	---

UNIT: mm	DRWN: RLM	THESE DRAWINGS AND SPECIFICATIONS ARE THE PROPERTY OF SPI AND SHALL NOT BE COPIED, USED OR RE-PRODUCED WITHOUT PERMISSION.	TITLE	
SCALE: NTS	DATE: 08/30/21		Commercial Back Shell	
	CHK'D: TRH		SPI P/N: SPI85049/83-XXX	REV: A
SHEET: 1 OF 1	APV'D: TRH		CUSTOMER P/N:	