

REVISIONS LIST				
REV	ECO #	DESCRIPTION	DATE	APV'D
A		Initial Release		

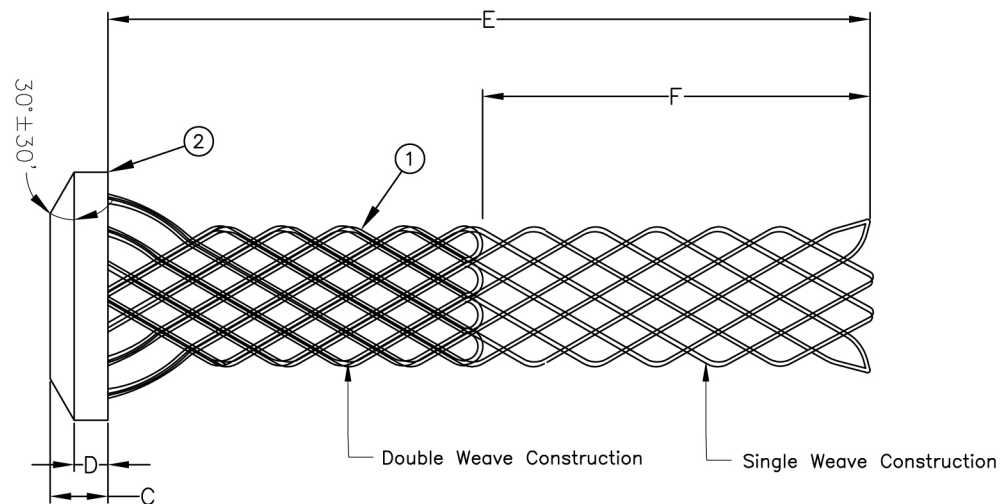
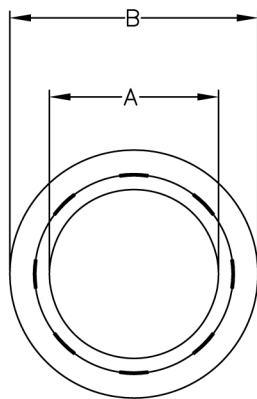

SPECIFICATIONS:

Salt Spray: 500 Hours

Cable Pull Out Strength: 250 Lbs for 1 Hour

Part Number	Insert Arrangements	A	B	C	D	E	F	Cable Range	
		+0.0/ -0.01	+0.02/ -0.0	±0.15	±0.005	APP	APP	Min	Max
MS90561-1	28-03, -05, -06 32-02, -04	1.797	0.969	0.450	0.250	8.000	4.500	0.832	0.969
MS90561-2	28-13 32-03, -05, -12	1.797	1.145	0.413	0.250	8.000	4.500	1.003	1.145
MS90561-12	28-07, -12 32-06	1.797	1.047	0.428	0.250	8.000	4.500	0.891	1.047
MS90561-13	32-13	1.797	1.342	0.366	0.250	9.500	5.320	1.185	1.342
MS90561-15	44-12	2.235	1.516	0.419	0.250	11.500	6.440	1.360	1.516
MS90561-16	44-13	2.235	1.688	0.375	0.250	13.500	7.580	1.531	1.688
MS90561-17	52-12	2.992	2.328	0.497	0.369	18.000	10.070	2.039	2.328
MS90561-18	52-13	2.992	2.500	0.453	0.369	19.000	10.630	2.211	2.500
MS90561-19	44-51	2.235	1.750	0.325	0.250	12.500	7.030	1.550	1.750
MS90561-20	44-52	2.235	1.579	0.406	0.250	12.000	6.750	1.375	1.579
MS90561-21	44-56	2.235	1.160	0.520	0.250	8.000	4.500	1.010	1.160

All Measurements Are In Inches

No.	Name	Material/Finish	Remarks
1	Wire	304 Stainless Steel	
2	Ring	304 Stainless Steel	

UNLESS NOTED TOLERANCES ARE:
.X ± 0.15 (0.38)
.XX ± 0.10 (0.25)
ANGLES ± 1°

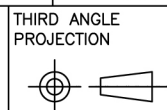

1170 S. PATTON ST.
XENIA, OHIO 45385
PH: (937) 374-2700
FX: (937) 374-2717

UNIT: In (mm)	DRWN: RLM	THESE DRAWINGS AND SPECIFICATIONS ARE THE PROPERTY OF SPI AND SHALL NOT BE COPIED, USED OR RE-PRODUCED WITHOUT PERMISSION.	TITLE MIL-DTL-22992 Class L Cord Grip	
SCALE: NTS	DATE: 04/23/14		S P I P / N : MS90561-XX	
	CHK'D: RLM		R E V : A	
SHEET: 1 OF 1	APV'D: RLM		C U S T O M E R P / N :	